



SCHNELL FARMS

GPS Address

19504 NE 19TH ST, Vancouver, WA 98684

Model Home

The Bridger Multi-Gen | 3,206 Sqft | 4 bed | 3.5 bath

Sales Contact

 Deondra | (360) 904-5879
 deondrac@buildplh.com

Sales Contact

 Victoria | (360) 869-8577
 victoriar@buildplh.com

TO BE BUILT

SITE	HOME PLAN	SQ FT	BED/BATH	GARAGES	ADDRESS	PRICE
1	The Wallowa - D	2,388	4 / 2.5	2-car	19400 NE 21ST ST	\$739,000
14	The Cascade - B	3,379	3-5 / 2.5-4.5	3-car	1901 NE 196TH AVE	\$1,075,000
18	The Aspen - G	3,122	3-4 / 3.5	3-car	1827 NE 196TH AVE	\$1,105,000
33	The Magnolia - E	3,217	4-5 / 3.5-4.5	3-car	1828 NE 196th AVE	\$919,000
34	The Deschutes - G	1,912	3 / 2	2-car	1830 NE 196TH AVE	\$704,000
35	The Jasper - F	2,844	4-6 / 2.5-4.5	3-car	1832 NE 196TH AVE	\$802,000
36	The Alpine - D	3,691	4-7 / 3.5-5	4-car tandem	1834 NE 196th AVE	\$946,000
38	The Juniper - B	2,205	3 / 2-3	3-car	1840 NE 196TH AVE	\$830,000
39	The Rainier - D	3,213	4-5 / 2.5-3.5	3-car	1841 NE 195TH AVE	\$898,000
42	The Alpine - B	3,691	4-7 / 3.5-5	4-car tandem	1829 NE 195TH AVE	\$965,000
43	The Laurelwood - S	2,258	3 / 2-3	3-car	1825 NE 195TH AVE	\$850,000
54	The Madison - F	3,182	5 / 3.5	2-car	19508 NE 19TH ST	\$798,000
57	The Rogue - B	2,527	3-5 / 2.5-3	3-car tandem	19520 NE 19TH ST	\$767,000

UNDER CONSTRUCTION

SITE	HOME PLAN	SQ FT	BED/BATH	GARAGES	ADDRESS	PRICE
9	The Rogue - D	2,527	4 / 3	3-car tandem	2011 NE 196TH AVE	\$842,000
50	The Wallowa - F	2,388	4 / 2.5	2-car	1808 NE 195TH AVE	\$729,000
67	The Bridger - G	3,181	4 / 3	3-car tandem	1909 NE 195TH CT	\$897,000

Square footage is approximate and subject to change. Completion dates are subject to change. Pre-Sale pricing is the base price. Permit Ready pricing includes structural options. Quick Move-In pricing includes structural and personal choice options. Pricing is subject to change. Pacific Lifestyle Homes, Broker. WA LIC# PACIFLH924RI; OR CCB# 173524.



SCHNELL FARMS

GPS Address

19504 NE 19TH ST, Vancouver, WA 98684

Model Home

The Bridger Multi-Gen | 3,206 Sqft | 4 bed | 3.5 bath

Sales Contact

Deondra | (360) 904-5879

deondrac@buildplh.com

Sales Contact

Victoria | (360) 869-8577

victoriar@buildplh.com

UNDER CONSTRUCTION (CONT.)

SITE	HOME PLAN	SQ FT	BED/BATH	GARAGES	ADDRESS	PRICE
77	The Madison - D	3,182	5 / 3.5	2-car	2012 NE 195TH CT	\$841,000



SCHNELL FARMS

GPS Address

19504 NE 19TH ST, Vancouver, WA 98684

SCHNELL FARMS – SITE MAP

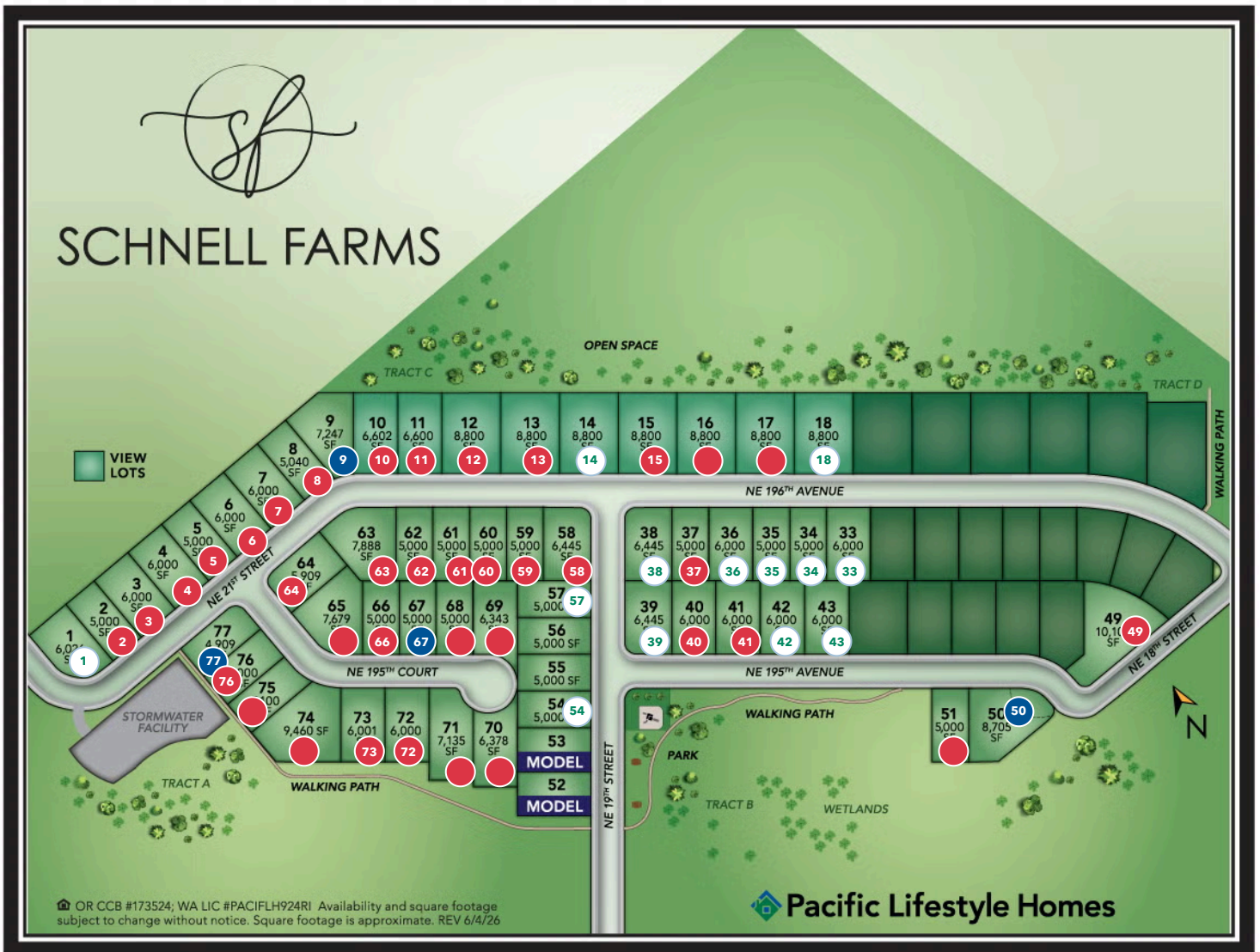

● Quick Move-In
 To Be Built / Design Center Ready
 ● Sold

Square footage is approximate and subject to change. Completion dates are subject to change. Pre-Sale pricing is the base price. Permit Ready pricing includes structural options. Quick Move-In pricing includes structural and personal choice options. Pricing is subject to change. Pacific Lifestyle Homes, Broker. WA LIC# PACIFLH924RI; OR CCB# 173524.