

GPS Address

4216 N 12th Way, Ridgefield, WA 98642

Model Home

The Holly | 2,098 sq ft. | 3 bed | 2.5 bath

Sales Contact

360-605-0246

info@buildplh.com

TO BE BUILT

SITE	HOME PLAN	SQ FT	BED/BATH	GARAGES	ADDRESS	PRICE
15	The Rogue - D	2,527	3-5 / 2.5-3	3-car	3603 N 12th Cir	\$789,000
46	The Alpine - D	3,691	4-7 / 3.5-5	4-car	1124 N Helens View Drive	\$1,017,000
90	The Evergreen - F	2,840	3-5 / 2.5-3	3-car	4203 N 11th Way	\$909,000
95	The Laurelwood - B	2,258	3 / 2-3	3-car	4313 N 11th Way	\$836,000
98	The Deschutes - D	1,912	3 / 2	2-car	4210 N 11th Way	\$795,000
106	The Tamarack - F	2,040	3 / 2	2-car	4201 N 12th Way	\$826,500
107	The Holly - B	2,119	3 / 2-2.5	3-car	4209 N 12th Way	\$814,000
108	The Sierra - B	2,893	3-5 / 2.5-3.5	3-car	4217 N 12th Way	\$881,000
155	The Pinehurst - H	1,991	3-4 / 2.5-3	3-car	4303 N 14th Way	\$735,000
156	The Deschutes - G	1,912	3 / 2	2-car	4311 N 14th Way	\$699,000
161	The Jasper - D	2,844	4-6 / 2.5-4.5	3-car	4401 N 14th Way	\$793,000
164	The Wallowa - F	2,388	4 / 2.5	2-car	1408 N 44th Place	\$757,000
170	The Eldridge - B	2,601	4 / 3	2-car	4400 N 15th Way	\$813,000
176	The Bridger - F	3,181	4-5 / 3-4	3-car	4320 N 15th Way	\$916,000
195	The Tamarack - D	2,040	3 / 2	2-car	4219 N 15th Way	\$768,000
198	The Sage - D	2,353	4-5 / 2.5-3	2-car	4115 N 15th Way	\$800,500

GPS Address

4216 N 12th Way, Ridgefield, WA 98642

Model Home

The Holly | 2,098 sq ft. | 3 bed | 2.5 bath

Sales Contact

360-605-0246

info@buildplh.com

DESIGN STUDIO READY

SITE	HOME PLAN	SQ FT	BED/BATH	GARAGES	ADDRESS	PRICE
188	The Fremont - D	3,226	4 / 2.5	3-car	4348 N 14th Way	\$861,000
189	The Mollala Bonus - D	2,542	2 / 3.5	2-car	4340 N 14th Way	\$876,000

UNDER CONSTRUCTION

SITE	HOME PLAN	SQ FT	BED/BATH	GARAGES	ADDRESS	PRICE
14	The Bridger - F	3,181	4 / 3	3-car	3523 N 12th Circle	\$869,000
186	The Sage - B	2,353	4 / 2.5	2-car	4339 N 15th Way	\$829,000

MODEL HOME FOR SALE

SITE	HOME PLAN	SQ FT	BED/BATH	GARAGES	ADDRESS	PRICE
74	The Holly - D	2,098	3 / 2.5	3-car	4216 N 12th Way	\$889,000



GPS Address

4216 N 12th Way, Ridgefield, WA 98642

PARADISE POINTE – SITE MAP



● Quick Move-In
 To Be Built / Design Center Ready
 Model Home
 ● Sold

Square footage is approximate and subject to change. Completion dates are subject to change. Pre-Sale pricing is the base price. Permit Ready pricing includes structural options. Quick Move-In pricing includes structural and personal choice options. Pricing is subject to change. Pacific Lifestyle Homes, Broker. WA LIC# PACIFLH924RI; OR CCB# 173524.



SALMON CREEK RIDGE

GPS Address

16906 NE 38th Ave, Vancouver, WA 98686

Model Home

The Shasta XXL | 3,756 SF | 5 bed | 3.5 bath

Sales Contact

360-605-0246

info@buildplh.com

TO BE BUILT

SITE	HOME PLAN	SQ FT	BED/BATH	GARAGES	ADDRESS	PRICE
11	The Laurelwood - D	2,258	3 / 2-3	3-car	16712 NE 38th Ave	\$843,000
44	The Shasta XXL - F	3,904	4-5 / 3.5-4	3-car	16906 NE 35th Ave	\$1,119,000
45	The Deschutes - B	1,912	3 / 2	2-car	16910 NE 35th Ave	\$909,000
46	The Aspen - B	3,122	3-4 / 3.5	3-car	16914 NE 35th Ave	\$980,000
47	The Shasta - C	2,958	3-4 / 2.5-3	3-car	16918 NE 35th Ave	\$985,000
64	The Bridger - F	3,181	4-5 / 3-4	3-car	3618 NE 169th Way	\$916,000
68	The Alpine - F	3,691	4-7 / 3.5-5	4-car	3607 NE 169th Way	\$939,000

QUICK MOVE-IN

SITE	HOME PLAN	SQ FT	BED/BATH	GARAGES	ADDRESS	PRICE
63	The Conifer - F	1,982	3 / 2	3-car	3614 NE 169th Way	\$749,000



SALMON CREEK RIDGE

GPS Address

16906 NE 38th Ave, Vancouver, WA 98686

SALMON CREEK RIDGE – SITE MAP



● Quick Move-In ○ To Be Built / Design Center Ready ● Sold

Square footage is approximate and subject to change. Completion dates are subject to change. Pre-Sale pricing is the base price. Permit Ready pricing includes structural options. Quick Move-In pricing includes structural and personal choice options. Pricing is subject to change. Pacific Lifestyle Homes, Broker. WA LIC# PACIFLH924RI; OR CCB# 173524.



SCHNELL FARMS

GPS Address

19504 NE 19TH ST, Vancouver, WA 98684

Model Home

The Bridger Multi-Gen | 3,206 Sqft | 4 bed | 3.5 bath

Sales Contact

360-605-0246

info@buildplh.com
TO BE BUILT

SITE	HOME PLAN	SQ FT	BED/BATH	GARAGES	ADDRESS	PRICE
1	The Wallowa - D	2,388	4 / 2.5	2-car	19400 NE 21ST ST	\$739,000
14	The Cascade - B	3,379	3-5 / 2.5-4.5	3-car	1901 NE 196TH AVE	\$1,075,000
18	The Aspen - G	3,122	3-4 / 3.5	3-car	1827 NE 196TH AVE	\$1,105,000
19	The St. Helens	2,596	3-4 / 2-3	2-car	1823 NE 196TH AVE	\$1,058,000
31	The Holly	2,119	3 / 2-2.5	3-car	1820 NE 196TH AVE	\$783,000
32	The Tamarack	2,040	3 / 2	2-car	1824 NE 196TH AVE	\$762,000
34	The Deschutes - G	1,912	3 / 2	2-car	1830 NE 196TH AVE	\$704,000
35	The Jasper - F	2,844	4-6 / 2.5-4.5	3-car	1832 NE 196TH AVE	\$802,000
36	The Alpine - D	3,691	4-7 / 3.5-5	4-car tandem	1834 NE 196th AVE	\$946,000
38	The Juniper - B	2,205	3 / 2-3	3-car	1840 NE 196TH AVE	\$830,000
39	The Rainier - D	3,213	4-5 / 2.5-3.5	3-car	1841 NE 195TH AVE	\$898,000
42	The Alpine - B	3,691	4-7 / 3.5-5	4-car tandem	1829 NE 195TH AVE	\$965,000
43	The Laurelwood - S	2,258	3 / 2-3	3-car	1825 NE 195TH AVE	\$850,000
44	The Shasta	2,958	3-4 / 2.5-3	3-car	1821 NE 195TH AVE	\$1,035,000
45	The Bridger	3,181	4-5 / 3-4	3-car tandem	1817 NE 195TH AVE	\$891,000
54	The Madison - F	3,182	5 / 3.5	2-car	19508 NE 19TH ST	\$798,000



SCHNELL FARMS

GPS Address

19504 NE 19TH ST, Vancouver, WA 98684

Model Home

The Bridger Multi-Gen | 3,206 Sqft | 4 bed | 3.5 bath

Sales Contact

360-605-0246

info@buildplh.com

UNDER CONSTRUCTION

SITE	HOME PLAN	SQ FT	BED/BATH	GARAGES	ADDRESS	PRICE
50	The Wallowa - F	2,388	4 / 2.5	2-car	1808 NE 195TH AVE	\$729,000
67	The Bridger - G	3,181	4 / 3	3-car tandem	1909 NE 195TH CT	\$897,000
77	The Madison - D	3,182	5 / 3.5	2-car	2012 NE 195TH CT	\$841,000



SCHNELL FARMS

GPS Address

19504 NE 19TH ST, Vancouver, WA 98684

SCHNELL FARMS – SITE MAP

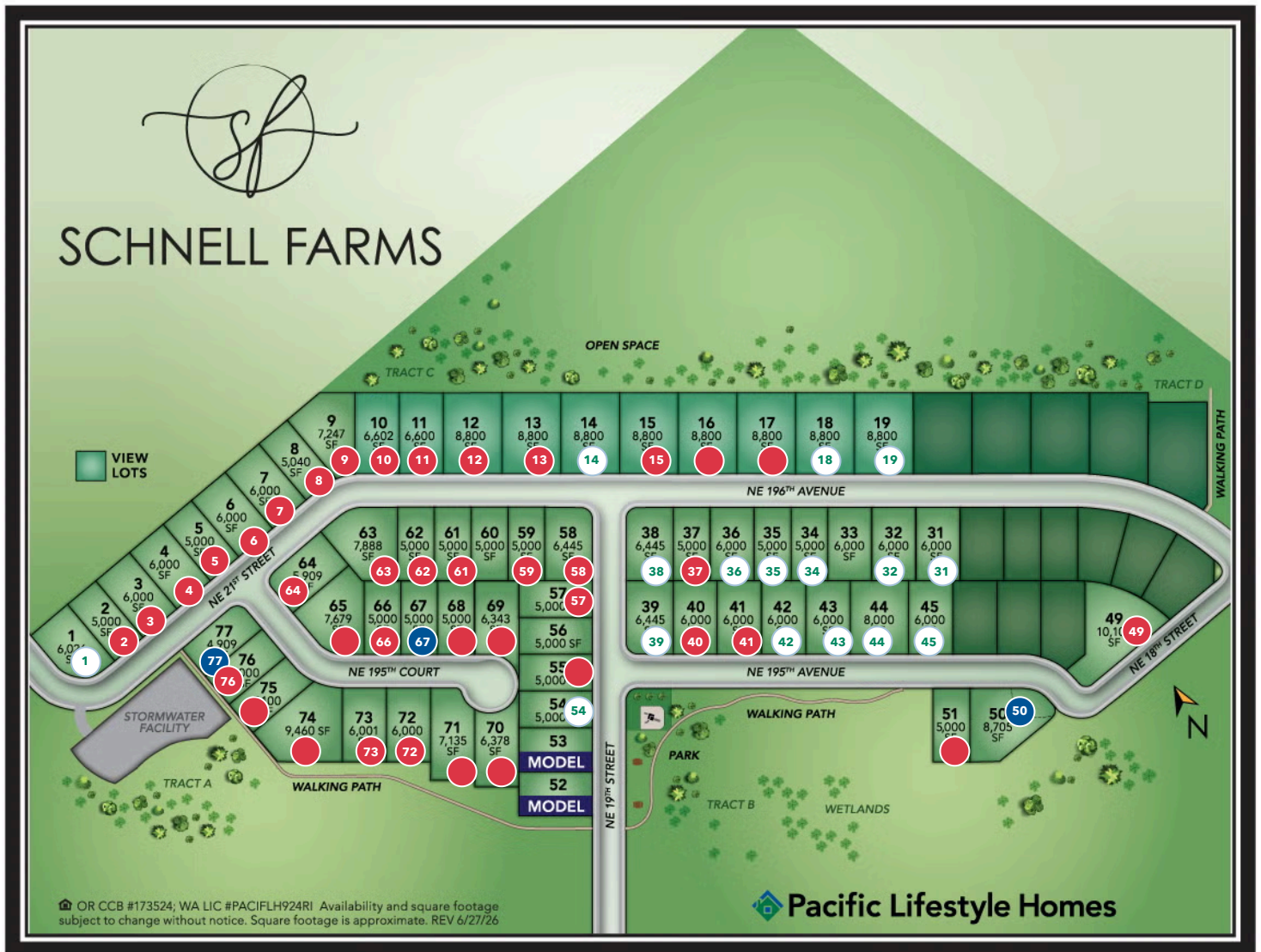

● Quick Move-In ○ To Be Built / Design Center Ready ● Sold

Square footage is approximate and subject to change. Completion dates are subject to change. Pre-Sale pricing is the base price. Permit Ready pricing includes structural options. Quick Move-In pricing includes structural and personal choice options. Pricing is subject to change. Pacific Lifestyle Homes, Broker. WA LIC# PACIFLH924RI; OR CCB# 173524.

**GPS Address**

8325 N Hargrave St, Camas, WA 98607

Model Home

The Molalla Bonus | 2,542 SF | 3 bed | 3 bath

Sales Contact

360-605-0246

TO BE BUILT

SITE	HOME PLAN	SQ FT	BED/BATH	GARAGES	ADDRESS	PRICE
26	The Rogue - D	2,527	3-5 / 2.5-3	3-car	8119 N Hargrave St	\$849,000

QUICK MOVE-IN

SITE	HOME PLAN	SQ FT	BED/BATH	GARAGES	ADDRESS	PRICE
29	The Deschutes - G	1,814	3 / 2	2-car	8263 N Hargrave St	\$749,000
33	The Molalla Bonus - H	2,542	3 / 3	2-car	8325 N Hargrave St	\$899,000

THE LANDING AT
GREEN MOUNTAIN

GPS Address

8325 N Hargrave St, Camas, WA 98607

THE LANDING AT GREEN MOUNTAIN – SITE MAP



 Quick Move-In  To Be Built / Design Center Ready  Sold

Square footage is approximate and subject to change. Completion dates are subject to change. Pre-Sale pricing is the base price. Permit Ready pricing includes structural options. Quick Move-In pricing includes structural and personal choice options. Pricing is subject to change. Pacific Lifestyle Homes, Broker. WA LIC# PACIFLH924RI; OR CCB# 173524.

THE NINES

AT CAMAS MEADOWS

GPS Address

4618 NW 71st Ave, Camas, WA 98607

Model Home

The Rogue | 2,527 SF | 4 bed | 3 bath

Sales Contact

360-605-0246

info@buildplh.com

TO BE BUILT

SITE	HOME PLAN	SQ FT	BED/BATH	GARAGES	ADDRESS	PRICE
26	The Sage - M	2,353	4-5 / 2.5-3	2-car	4672 NW 71st Ave	\$840,000
27	The Wallowa - D	2,388	4 / 2.5	2-car	4688 NW 71st Ave	\$832,000
34	The Evergreen - H	2,840	3-5 / 2.5-3	3-car	4615 NW 71st Ave	\$1,369,000
35	The Laurelwood - S	2,258	3 / 2-3	3-car	4627 NW 71st Ave	\$1,287,000
37	The Sierra - D	2,893	3-5 / 2.5-3.5	3-car	4661 NW 71st Ave	\$1,335,000
42	The Rainier - F	3,213	4-5 / 2.5-3.5	3-car	4735 NW 71st Ave	\$1,454,000
44	The Jefferson - H	2,500	3-4 / 2.5	4-car	4749 NW 71st Ave	\$1,353,000
49	The Lewis - A	2,305	4-5 / 2.5-3.5	2.5-car	4788 NW 71st Ave	\$851,000

QUICK MOVE-IN

SITE	HOME PLAN	SQ FT	BED/BATH	GARAGES	ADDRESS	PRICE
28	The Eldridge - G	2,601	4 / 3	2-car	4702 NW 71st Ave	\$854,000

THE NINES

AT CAMAS MEADOWS

GPS Address

4618 NW 71st Ave, Camas, WA 98607

THE NINES AT CAMAS MEADOWS GOLF COURSE HOMES – SITE MAP



 Quick Move-In  To Be Built / Design Center Ready  Sold

Square footage is approximate and subject to change. Completion dates are subject to change. Pre-Sale pricing is the base price. Permit Ready pricing includes structural options. Quick Move-In pricing includes structural and personal choice options. Pricing is subject to change. Pacific Lifestyle Homes, Broker. WA LIC# PACIFLH924R1; OR CCB# 173524.

THE NINES

AT CAMAS MEADOWS

GPS Address

4607 NW Camas Meadows Drive, Camas, WA 98607

Model Home

The Camaloch | 2,117 SF | 3 bed | 2.5 bath

Sales Contact

None

info@buildplh.com

TO BE BUILT

SITE	HOME PLAN	SQ FT	BED/BATH	GARAGES	ADDRESS	PRICE
4	The Astoria - F	1,854	3 / 2.5	2-car	4699 NW Camas Meadows Dr	\$666,000
5	The Bandon - F	1,976	3-4 / 2.5	2-car	4697 NW Camas Meadows Dr	\$578,000
6	The Bandon - F	1,976	3-4 / 2.5	2-car	4695 NW Camas Meadows Dr	\$578,000
7	The Camaloch - D	2,117	3-4 / 2.5-3.5	2-car	4693 NW Camas Meadows Dr	\$677,000

UNDER CONSTRUCTION

SITE	HOME PLAN	SQ FT	BED/BATH	GARAGES	ADDRESS	PRICE
8	The Camaloch - D	2,117	3 / 2.5	2-car	4667 NW Camas Meadows Drive	\$715,000
9	The Bandon - E	1,976	3 / 2.5	2-car	4665 NW Camas Meadows Dr	\$619,000
10	The Bandon - E	1,976	3 / 2.5	2-car	4663 NW Camas Meadows Dr	\$619,000
11	The Camaloch - D	2,117	3 / 2.5	2-car	4661 NW Camas Meadows Dr	\$733,000
13	The Bandon - F	1,976	4 / 2.5	2-car	4637 NW Camas Meadows Dr	\$636,000
14	The Bandon - F	1,976	4 / 2.5	2-car	4635 NW Camas Meadows Dr	\$641,000
15	The Camaloch - F	2,117	3 / 2.5	2-car	4633 NW Camas Meadows Dr	\$739,000
60	The Camaloch - E	2,117	3 / 2.5	2-car	4721 NW Camas Meadows Dr	\$743,000
62	The Camaloch - E	2,117	3 / 2.5	2-car	4725 NW Camas Meadows Dr	\$734,000

QUICK MOVE-IN

SITE	HOME PLAN	SQ FT	BED/BATH	GARAGES	ADDRESS	PRICE
1	The Camaloch - F	2,117	3 / 2.5	2-car	4705 NW Camas Meadows Dr	\$669,000

Square footage is approximate and subject to change. Completion dates are subject to change. Pre-Sale pricing is the base price. Permit Ready pricing includes structural options. Quick Move-In pricing includes structural and personal choice options. Pricing is subject to change. Pacific Lifestyle Homes, Broker. WA LIC# PACIFLH924RI; OR CCB# 173524.

THE NINES

AT CAMAS MEADOWS

GPS Address

4607 NW Camas Meadows Drive, Camas, WA 98607

Model Home

The Camaloch | 2,117 SF | 3 bed | 2.5 bath

Sales Contact

None

info@buildplh.com

QUICK MOVE-IN (CONT.)

SITE	HOME PLAN	SQ FT	BED/BATH	GARAGES	ADDRESS	PRICE
57	The Camaloch - F	2,117	3 / 2.5	2-car	4715 NW Camas Meadows Dr	\$649,000

THE NINES

AT CAMAS MEADOWS

GPS Address

4607 NW Camas Meadows Drive, Camas, WA 98607

THE NINES AT CAMAS MEADOWS TOWNHOMES – SITE MAP



- Quick Move-In
- To Be Built / Design Center Ready
- Sold

Square footage is approximate and subject to change. Completion dates are subject to change. Pre-Sale pricing is the base price. Permit Ready pricing includes structural options. Quick Move-In pricing includes structural and personal choice options. Pricing is subject to change. Pacific Lifestyle Homes, Broker. WA LIC# PACIFLH924R1; OR CCB# 173524.