

Contact Us

Phone: (877) 500-5675

Email: info@buildplh.com

7929 W Flathead Lake St

Eagle, ID 83616

Priced At

\$959,800

The Estates at Eagle Ridge

The Evergreen Floor Plan

- 2840
Square Feet
- 3
Bedrooms
- 2.5
Bathrooms
- 3
Car Garage



Welcome to the Evergreen, a spacious and versatile home designed with modern living in mind. Offering 2,802 square feet, 3-5 bedrooms, and 2.5-3 bathrooms, this plan is perfect for growing families or those seeking ample space for work, play, and relaxation.

Upon entering, you'll find a generous den and a convenient powder room. The den can easily be converted into a 4th bedroom, while the powder room can be upgraded to a full bathroom, providing added flexibility. As you move deeper into the home, the open-concept layout reveals a large kitchen that flows into the dining area and expansive great room, creating the perfect setting for entertaining or casual family gatherings. The kitchen features a spacious pantry with plenty of storage, and the dining nook leads seamlessly to the covered patio for effortless indoor-outdoor living.

The great room boasts impressive 12-foot ceilings and large windows, allowing natural light to flood the space. Tucked just beyond the great room is the luxurious primary suite, complete with a spa-like bathroom featuring a soaking tub, walk-in shower, dual vanities, a private powder room, and an expansive walk-in closet that offers the option for a stacked washer and dryer.

Upstairs, you'll discover a versatile loft, perfect as a media room or play area, which can also be converted into a 5th bedroom if needed. Two additional bedrooms and a full bathroom complete the second floor, offering plenty of room for guests or family.

The Evergreen plan also includes a 3-car garage, providing ample storage and parking space for all your needs. With its thoughtful layout and numerous options for customization, the Evergreen is a perfect blend of comfort, style, and functionality.

Square footage is approximate and subject to change. Completion dates are subject to change. Pre-Sale pricing is the base price. Permit Ready pricing includes structural options. Quick Move-In pricing includes structural and personal choice options. Pricing is subject to change. Pacific Lifestyle Homes, Broker. WA LIC# PACIFLH924RI; OR CCB# 173524.



Contact Us

Phone: (877) 500-5675
Email: info@buildplh.com

7929 W Flathead Lake St

Eagle, ID 83616

The Evergreen Floor Plan

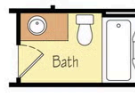

Optional Bath 3

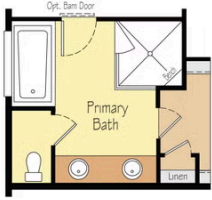

Optional Custom Glass Shower



Square footage is approximate and subject to change. Completion dates are subject to change. Pre-Sale pricing is the base price. Permit Ready pricing includes structural options. Quick Move-In pricing includes structural and personal choice options. Pricing is subject to change. Pacific Lifestyle Homes, Broker. WA LIC# PACIFLH924RI; OR CCB# 173524.